

**MOZART**®

**FINEST IN BLADES**

# PEAK QUALITY BLADES

QUALITY MADE IN SOLINGEN · SINCE 1923





## The right blade for every application.

Keen blades have been the hallmark of Solingen's industry for centuries and it is here we made our home in 1923. As a family firm, now managed by the fourth generation, we manufacture over 100 million blades every year to the full satisfaction of our customers. With over 100 fully-qualified staff, we are today one of the world's leading manufacturers of blades for technical and industrial applications.

Our products are in use wherever efficient cutting applications are required. Trapezoid and hooked blades for professional flooring experts, snap-off and scraper blades for painters and decorators, deburring cutters and blades for the plastics industry and special-purpose blades for processing fibers and fleece, for cutting film and numerous specialist blades for customer-specific applications form the foundations of our blade-development skills.



MOZART KLINGEN

Qualität  
seit 1923



MADE IN  
SOLINGEN

## Why MOZART?

- excellent value-for-money and consistently high quality
- direct contacts to ensure smooth communication
- flexible, lean organisational structure
- large standard range
- customer-specific adaptations
- support for your product development
- assistance with complex cutting challenges

## MOZART - uncompromising premium quality.

MOZART blades are crafted in sophisticated production processes and do not leave the factory until stringent quality controls have been carried out.

As one of the world's leading manufacturers of blades, MOZART is committed to Germany as a high-grade production location. Cutting-edge technology and highly accurate manufacturing methods guarantee the quality standard appreciated the world over: "100% made in Solingen".

To ensure this standard is maintained, MOZART has installed a certified quality management system to DIN EN ISO 9001.

# MOZART · The right tool for your **trade.**



**Allegro #1000.00**  
Robust, integrated universal cutting knife,  
incl. sheath and 5 blades 975.065



**Trimming knife #1600.00**  
The easy but safe way to skive the  
welded seams in PVC and linoleum flooring

**SpeedTrimmer #1610.00**  
Fast and ergonomic, the ideal  
tool for trimming welded  
seams in medium-sized  
to large projects



**9 mm snap-off knife #4095.00**  
Stainless steel knife, incl. snap-off tool  
and 3 blades 90.040



**18 mm snap-off knife #6180.00**  
Sturdy knife with steel blade guides,  
incl. 3 blades 180.050

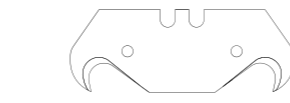

**Hook blade #110.065**  
51 x 18.8 x 0.63 mm

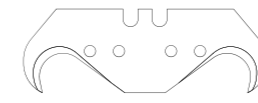

**Super-hook blade #105.065**  
54.8 x 18.8 x 0.63 mm

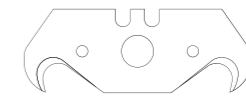

**Hook blade #104.064**  
51 x 18.8 x 0.63 mm, with centre hole 7.2 mm

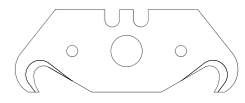

**Hook blade #117.064**  
51 x 18.8 x 0.63 mm, with levelled-off tips,  
centre hole 7.2 mm

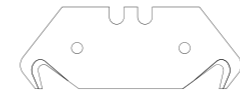

**Safety hook blade #112.064**  
51.2 x 18.8 x 0.63 mm, with a very tight hook

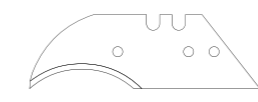

**Half-moon blade #160.065**  
59 x 18.8 x 0.63 mm

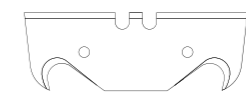

**Compound (double-bevel) blade #130.065**  
53.8 x 18.8 x 0.63 mm, blade-back ground

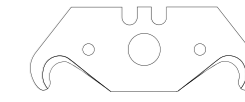

**Safety hook blade #117.068**  
51 x 18.8 x 0.63 mm, with rounded tips,  
centre hole 7.2 mm

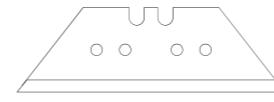

**Trapezoid blade #975.065**  
60 x 18.8 x 0.63 mm, with broad bevel 2.1 mm

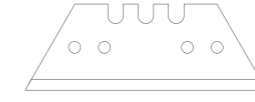

**Trapezoid blade #900.065**  
53 x 18.8 x 0.63 mm, with broad bevel  
2.1 mm

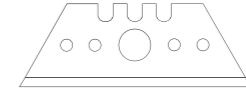

**Trapezoid blade #905.065**  
53 x 18.8 x 0.63 mm, with broad bevel  
2.1 mm, centre hole 7.2 mm

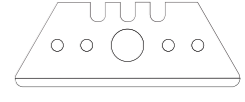

**Safety trapezoid blade #906.065**  
50 x 18.8 x 0.63 mm, with rounded tips, broad  
bevel 2.1 mm, centre hole 7.2 mm

**Snap-off blade 18 mm #180.050  
and #180.051**  
109.4 x 18 x 0.50 mm, 180.051  
with extra-broad, extremely  
sharp ground finish



**Polystyrene blade 18 mm  
#980.050**  
104.9 x 18 x 0.63 mm,  
unsegmented



**Snap-off blade 9 mm #90.040**  
94.5 x 8.9 x 0.40 mm



**Snap-off blade 9 mm #91.040**  
84.4 x 8.9 x 0.40 mm



**Snap-off blade 9 mm #93.040**  
86 x 8.9 x 0.40 mm,  
60° notch angle

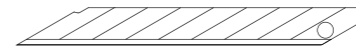

**Polystyrene blade 9 mm  
#92.039**  
84.4 x 8.9 x 0.40 mm,  
unsegmented

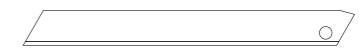

**Scraper blade 100 mm  
Working width**  
100 x 14 or 17.4 mm, available in  
thicknesses of 0.40 and 0.50 mm



**Cello blade #884.040**  
57 x 18.8 x 0.40 mm

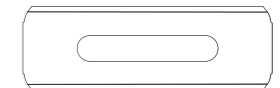

**Trimming blade #8678.000**  
for use with trimming knife and  
SpeedTrimmer

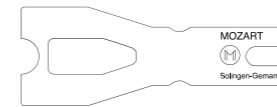

**Spacer claw #8679.000 (PVC) and  
#8700.000 (linoleum)**  
for use with trimming knife and  
SpeedTrimmer

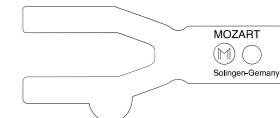

MOZART · Every cut is an **accurate cut.**

## MOZART precision-cut knife

The ideal tool for:

- neat deburring of plastic parts
- cutting leather
- graphic design
- all kinds of precision cutting



**Workstation #20.031**  
Safe, tidy storage for knife handles, incl. slots for blade dispenser and holder for used blades



**Precision-cut knife with knurled screw**  
for fast blade changes without tools  
7F (2514.02) slim knife for very fine cuts  
8F (2515.04) powerful, ergonomically designed knife  
9F (2515.05) as for 8F, but with additional thread for attaching a mandrel



**Precision-cut knife with oval-head Allen screw**  
prevents scratch damage to workpieces  
1F (2514.00) slim knife for finest cuts  
3F (2515.00) powerful, ergonomically designed knife  
5F (2515.02) as for 3F, but with additional thread for attaching a mandrel  
For knives 1F-5F, we recommend the protective cap with the integrated Allen key for quick & easy blade changes



## PRECISION-CUTTING BLADES

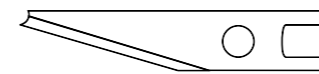

**Standard blade F1 #512.050**  
also suitable for scraping



**Safety blade F4 #512.052**  
with rounded tip

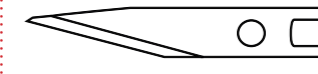

**Special blade F22 #512.063**  
for accurate plunge-cutting thanks to the exposed tip

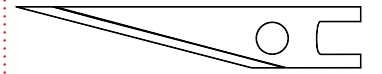

**Pointed blade F3 #512.053**  
with a particularly fine tip for precise cutting

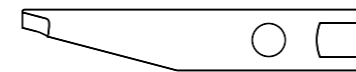

**Safety blade F17 #512.059**  
for very shallow cuts



**Hook blade F18 #512.060**  
for optimum plunge-cutting and radius cutting



**Special blade F23 #512.884**  
particularly robust thanks to a blade thickness of 0.88 mm

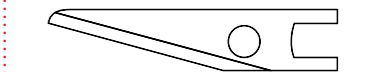

**Special blade F21 #512.062**  
with rounded tip and reduced length, for controlled cutting



# SLITTING & PERFORATION



**Injector blade**  
38 x 8 x 0.25 mm  

Carb. steel	Stainless	Stainless + TiN
640.025	642.025	90642.025

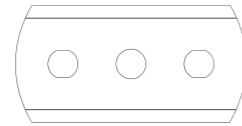

**Three-hole blade, rounded ends**  
43 x 22 mm  

Blade thickness	Carb. steel	Stainless	Stainless + TiN
0.10 mm	#40.010		
0.15 mm	#40.015	#42.015	90042.015
0.20 mm	#40.020	#42.020	90042.020
0.25 mm	#40.025		
0.30 mm	#40.030	#42.030	90042.030
0.40 mm	#40.040		

  
(with broad bevel)

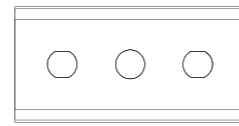

**Three-hole blade, straight ends**  
43 x 22 mm  

Blade thickn.	Carb. steel	Stainless	Stainless + TiN
0.10 mm	#80.010		
0.15 mm	#80.015	#82.015	#90082.015
0.20 mm	#80.020	#82.020	#90082.021
0.25 mm	#80.025		
0.30 mm	#80.030	#82.030	#90082.030
0.40 mm	#80.040		

  
(with broad bevel)

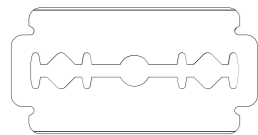

**Industrial blade**  
43 x 22 mm  

Blade thickn.	Carb. steel	Stainless	Stainless + TiN
0.10 mm	#310.010	#331.010	
0.15 mm	#310.015	#331.015	#90331.015
0.20 mm	#310.020		

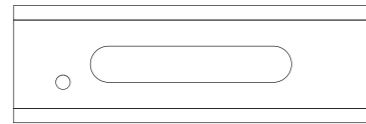

**Cello blade, straight ends**  
57 x 18.8 x 0.40 mm  

Carb. steel	Stainless	Carb. steel + TiN	Stainless + TiN
#881.040	#881.044	#90881.040	#90881.044

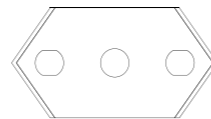

**Special three-hole blade #450.020**  
42 x 22.4 x 0.20 mm, stainless

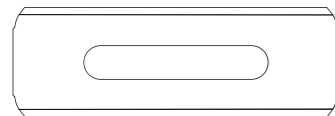

**Cello blade, narrow bevel #884.040**  
57 x 18.8 x 0.40 mm, carbon steel

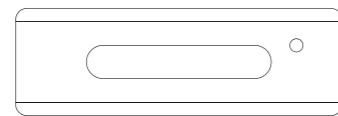

**Cello blade, rounded ends**  
57 x 18.8 x 0.40 mm  

Carb. steel	Carb. + TiN
#880.040	#90880.040

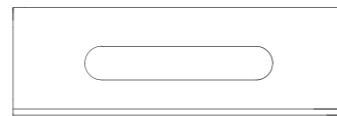

**Cello blade, single-sided, narrow bevel #886.038**  
57 x 18.8 x 0.40 mm, stainless

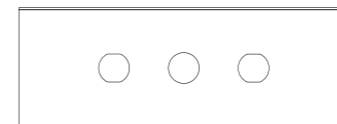

**Industrial blade**  
60 x 22 mm  

Blade thickn.	Carb. steel	Stainless	Stainless + TiN
#856.022	#856.023	#90856.024	#90856.023

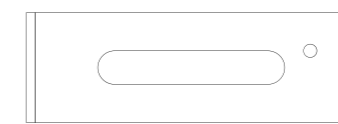

**Hot-cut blade, ground on one side #8933.001**  
19 x 57 x 0.40 mm, carbon steel

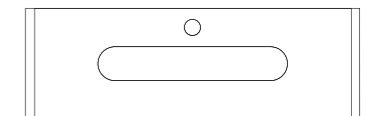

**Hot-cut blade, ground on both sides #8933.000**  
19 x 57 x 0.40 mm, carbon steel

MOZART BLADES · so sharp they need extra **protection.**



# MOZART · A cut above the rest for **textiles & fibers**.

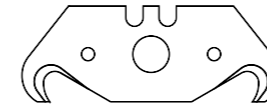

**Hook blade #117.064**  
51 x 18.8 x 0.63 mm with levelled tips,  
centre hole 7.2 mm



**Staple fiber blade #80756.000**  
64 x 7.9 x 0.884 mm  
**Stainless** #80756.000    **Stainless + TiN** #92021.000

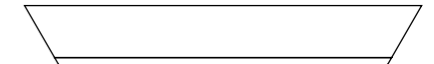

**Fiberglass blade #80758.195**  
15.8 x 0.87 mm  
**Length**    **Order No.**  
195 mm    #80758.195  
248 mm    #80758.248

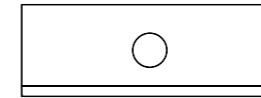

**Fiberglass blade #80235.001**  
22.3 x 8 x 0.25 mm

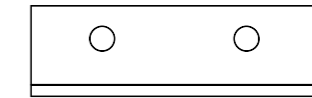

**Fiberglass blade #80261.000**  
25.4 x 8 x 0.25 mm



**Staple fiber blade Mark V**  
117.5 x 15.7 x 0.884 mm  
**Stainless** #80751.118    **Stainless + TiN** #92010.118    **Stainless + CrN** #94010.118    **Stainless + TiCN** #94010.118

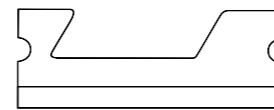

**Staple fiber blade #80782.000**  
32.2 x 12.1 x 0.68 mm

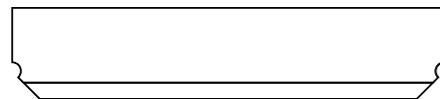

**Staple fiber blade Mark IV**  
74.6 x 15.7 x 0.884 mm  
**Stainless** #80750.076    **Stainless + TiN** #92005.076    **Stainless + CrN** #93005.076    **Stainless + TiCN** #94005.076

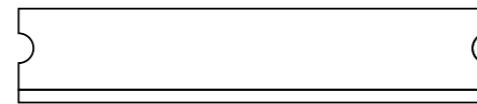

**Staple fiber blade for Herkules**  
95 x 19 x 0.884 mm  
**Stainless** #80760.096    **Stainless + TiN** #92009.096    **Stainless + CrN** #93009.096    **Stainless + TiCN** #94009.096

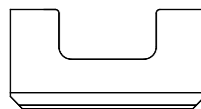

**Staple fiber blade #80783.007**  
16 x 8 x 0.48 mm

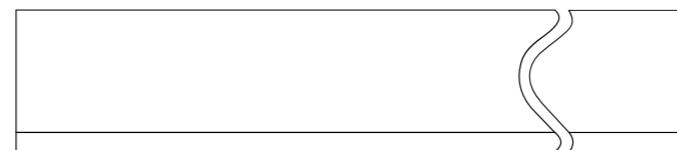

**Staple fiber blade for Fleissner**  
140 x 18.9 x 0.884 mm  
**Stainless** #80765.140    **Stainless + TiN** #92002.140    **Stainless + TiCN** #94002.140

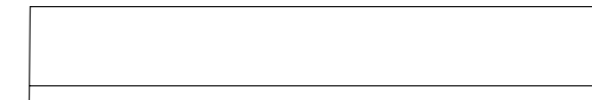

**Staple fiber blade #80453.000**  
48 x 8 x 0.50 mm  
**Carb.steel** #80453.000    **Stainless** #80455.000

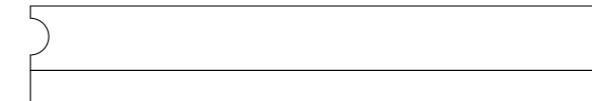

**Staple fiber blade**  
48 x 7.9 x 0.884 mm  
**Stainless** #80451.001    **Stainless + TiN** #92017.048

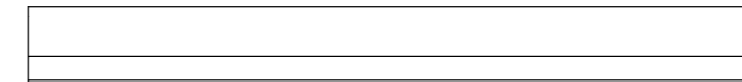

**Staple fiber blade**  
76.5 x 7.9 x 0.884 mm  
**Stainless** #80551.000    **Stainless + TiN** #92019.088

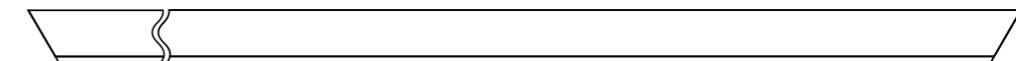

**Fiberglass blade #80686.000**  
135 x 8 x 0.30 mm



MOZART · **Special-purpose blades.**  
As individual as your needs.



MOZART · The art is in the details.

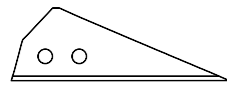

**Special-purpose blade #8022.000**  
45 x 15 x 0.30 mm

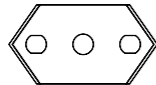

**Special three-hole blade #450.020**  
42 x 22.4 x 0.20 mm

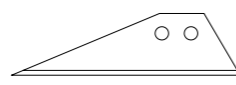

**Special-purpose blade #8095.000**  
51 x 14 x 0.50 mm

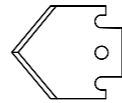

**Special-purpose blade #8758.000**  
30.4 x 25 x 0.50 mm

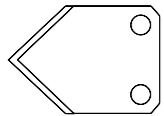

**Special-purpose blade #8757.000**  
45 x 31.9 x 0.80 mm



**Special-purpose blade #809.025**  
39.2 x 18.8 x 0.25 mm

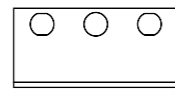

**Special-purpose blade #805.030**  
39 x 18.8 x 0.30 mm

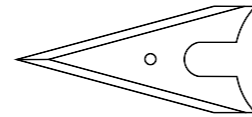

**Special-purpose blade #8308.000**  
45 x 20 x 0.90 mm

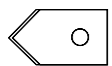

**Special-purpose blade #8237.001**  
18 x 10 x 0.20 mm

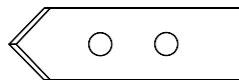

**Special-purpose blade #8237.000**  
33.5 x 10 x 0.20 mm

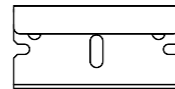

**Reinforced scraper blade #610.030**  
39.6 x 19.6 x 0.30 mm

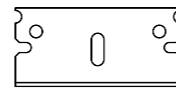

**Self-stropping blade #600.030**  
39 x 18.7 x 0.30 mm

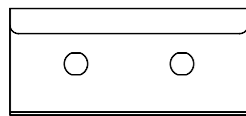

**Reinforced scraper blade #860.030**  
57 x 24.8 x 0.28 mm

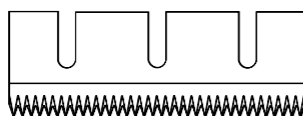

**Toothed blade #80945.000**  
85 x 30 x 1.5 mm

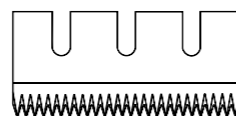

**Toothed blade #80944.000**  
65 x 30 x 1.5 mm

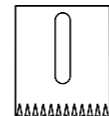

**Toothed blade #80942.000**  
32 x 41 x 1.6 mm

MOZART small-batch runs  
and prototyping

Special-purpose blades can be made to your individual specifications. To do so, we make full use of state-of-the-art laser technology and machinery developed by us in-house to optimise this process. The results have to be used to be believed.

- Peak precision
- Individual down to the last detail
- For order quantities of one or more

- Blade thickness 0.10 - 1 mm
- Double-sided ground geometry, double bevel, or single-sided, double bevel
- Material is high-alloyed carbon steel or stainless steels







**Pedi plastic corn-shaver #2004.00**  
Safety assured thanks to accurate cutting and ergonomic handling



**Original Pedi blades #50.013**  
Professional quality, made in Solingen



**by MOZART**  
Professional quality corn-shaver blades and holders

## MOZART · Packaging the best protection for our premium blades.



**Universal cutter blades**  
10 blades in safe dispenser / 10 dispensers in display box / 10 display boxes in outer



**Pedi Classic corn-shaver #2000.00**  
with chrome-plated front end



**Pedi plastic corn-shaver #2004.00**  
in POS packaging, incl. 1 stainless blade



**Original Pedi blades #50.013**  
2 x 10 blades in POS packaging

**Precision-cutting blades**  
100 blades in safe dispenser / 10 dispensers in outer



**Pedi Classic corn-shaver #2002.00**  
with chrome-plated front end, improved ergonomics



**Pedi Classic corn-shaver #2002.00**  
in POS packaging



**Original Pedi blades #50.013**  
10 x 10 packs in counter-top display

**Industrial blades**  
100 – 350 blades in the MOZART blade box / 5 boxes in outer (fill quantities depend on blade thickness)  
Alternatively:  
1 blade in paraffin packaging / 200 blades in display box / 5 display boxes in outer



**POS friendly packaging, displays and counter-top displays**  
to customers' specifications



# MOZART

Your partner  
in blades

---

100% made in Solingen

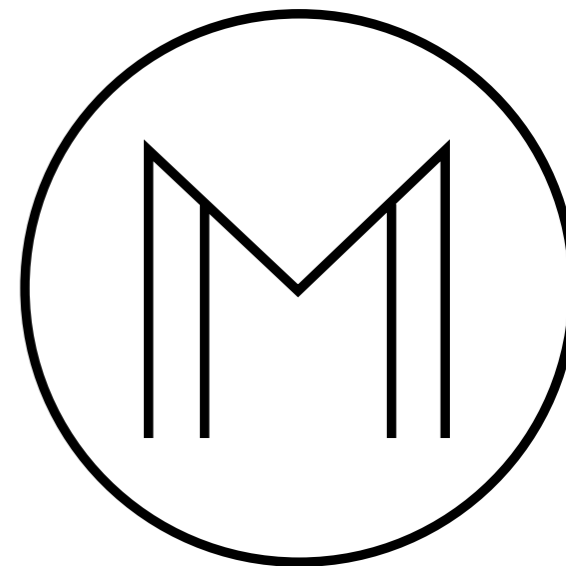

# MOZART · From high-grade steel to the perfect blade.

## The recipe for perfect blades

### Highest-quality steel for the perfect MOZART blade.

At MOZART, we only process hand-picked strip steel sourced from certified suppliers. Every batch delivered is subjected to stringent quality checks in our laboratory before it is allowed to be used in production. Only steels that comply fully with our ambitious quality standards in terms of surface, edge quality, carbide density and carbide distribution are passed by our quality control experts and released for blade production.

## Grinding to the closest tolerances.

### We know what customers want.

Does your cutting application benefit from a very specific grinding geometry? Whether one-sided or two-sided, single or double cutting edges, concave or roof-shaped – by making full use of our state-of-the-art grinding equipment, some of which is laser controlled, we are able to put virtually any customer-specific

ONE-SIDED · SINGLE BEVEL



ONE-SIDED · DOUBLE BEVEL



TWO-SIDED · SINGLE BEVEL



TWO-SIDED · DOUBLE BEVEL



GROUND DIMENSIONS

a: Honed width  
b: Honing angle  
c: Ground width  
d: Grinding angle

OTHER DIMENSIONS

e: Blade width  
f: Blade thickness  
g: Blade length

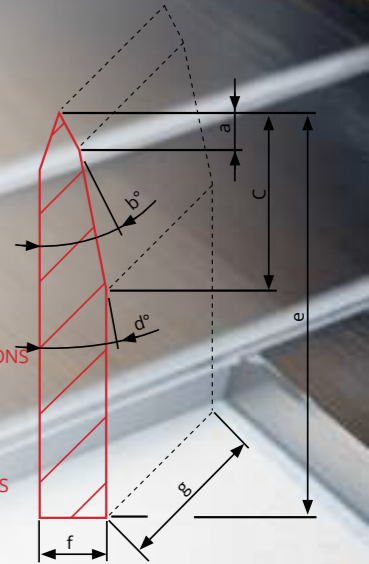

## Fire and ice.

### MOZART ice-hardening

After blanking, our strip steel is hardened to the required degree in a three-stage process. The steel is heated in sensor-controlled straight-through furnaces in a hydrogen atmosphere. This is followed by the ice-hardening stage, at  $-80^{\circ}\text{C}$ , and this is followed by a brief annealing stage to remove stresses. This high-precision process enables us to achieve the ideal mix of hardness and toughness, and very close tolerances of  $\pm 1$  HRC are standard in our production processes.

## MOZART coatings – for that extra boost to product lifetime in your production process.

### The right coating for every application.

- TiN** the most popular hard coating in the blade-making industry: provides high abrasive resistance and two to four-fold service lifetime extensions
- CrN** the considerably reduced inherent stress in comparison with TiN coatings makes CrN an interesting alternative in cutting applications involving higher bending loads
- TiCN** an excellent compromise between high abrasive resistance and low coefficient of friction
- DC** Outstanding abrasive resistance coupled with low coefficient of friction. As a result of its very high hardness, DC coatings are highly susceptible to localised pressure loads

## MOZART production · **quality in series production.**

High-alloyed strip steel sourced from certified suppliers



High-accuracy blanking



3-stage ice-hardening for a uniform molecular structure



Grinding to the closest tolerances

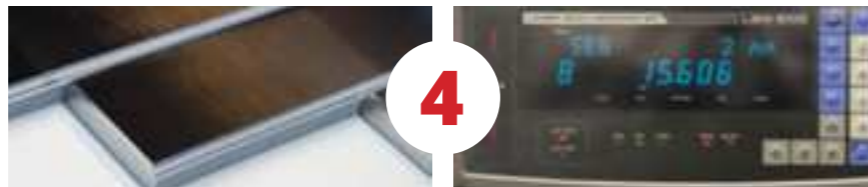

## **We are MOZART.**



**RESPONSIBILITY**

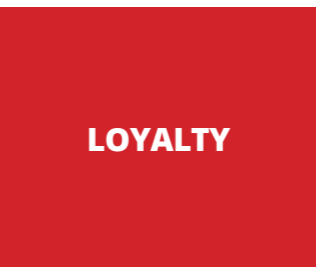

**MOZART**<sup>®</sup>  
**FINEST IN BLADES**

100 employees · 100 million blades.  
100% made in Solingen.



Mozart AG  
Schmalzgraben 15  
42655 Solingen, Germany  
Tel. +49 212 2209-0

[www.mozart-blades.com](http://www.mozart-blades.com)

